



# Lobee Pump & Machinery Co.

## Industrial Pumps and Accessories

Since 1899...Noted for Highest Quality Pumps and Equipment

## Process Pumps for Industry

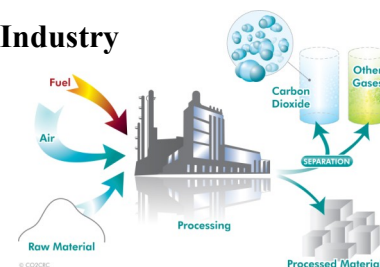

Completely 'Made in the USA', not just "designed, assembled and tested."

## POSITIVE DISPLACEMENT PUMP UNITS - 1/3 TO 5 HP

Lobee Positive Displacement Pump Units are now available in a range of sizes and configurations. Standard built to order pump units come in 1/3, 1/2, 3/4, 1, 1-1/2, 2, 3 and 5 HP ratings. Each unit is assembled to customer specification including pump type, flow and pressure rating, with or without relief valve, direct or base mounted, and coupled to ODP, TEFC(NV), Wash-Down or Explosion-Proof motor. Designed for pumping viscosities from water to molasses. Speed control options include 1200 RPM Motor, Mechanical Gear Reducers and VFD (Variable Frequency Drive).

### Typical Applications:

- Food oils, syrups, coatings and additive transfer
- Water, glycol and oil based coolant and heating systems
- Laboratory chemical and solution testing
- Marine fresh water systems
- Caustic and corrosive fluid transfer
- Liquids mixing systems
- Filtration and circulation systems

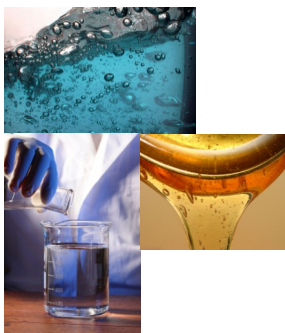

### Standard Features and Benefits

- ✓ Base or Direct Mounted Units
- ✓ Up to 5 HP, Motors are 56 to 215 Frame, Single and Three Phase, ODP, TEFC (NV), Wash-Down, Explosion Proof, available in Standard, High and Premium Efficient
- ✓ Flows to 30 GPM
- ✓ Viscosity to 100,000 SSU
- ✓ Choose from any Lobee Gear Pump—316 and Alloy 20 Stainless Steel, Federalloy™ Bronze, or Cast Iron
- ✓ Port sizes from 1/8" to 1-1/2" NPT
- ✓ Multiple Shaft Seal Options
- ✓ 0-1800 RPM Range of Operation
- ✓ Bi-Directional Shaft Rotation
- ✓ Operating Temperatures to 450° F
- ✓ Continuous Working Pressure up to 150 PSI
- ✓ Integral In-Pump or Externally Plumbed Adjustable Relief Valves

### Pump Shaft Sealing Systems Include:

1. Graphite or PTFE Packing
2. Buna or Viton™ Lip Seal
3. Mechanical Seals: Type 2106 Viton™, Type 1 Viton and Type 9 PTFE are Standard Options
4. Specialty Sealing and Flush Systems Available



### Direct Mounted Pump Units

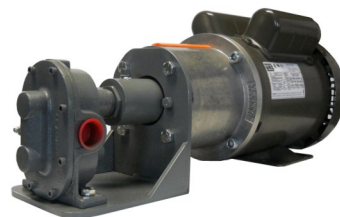

Model 6LOI with Single Phase TEFC Motor



Model 2LOX 316 SS with Explosion Proof Motor

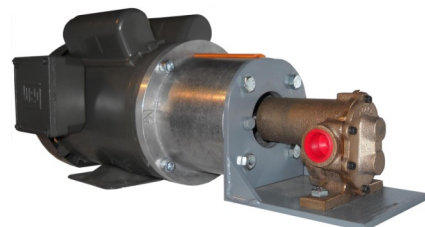

Model 6LOM with Single Phase TEFC Motor

### Base Mounted Pump Units



Model 8LOL with Gear Reducer/TEFC Motor

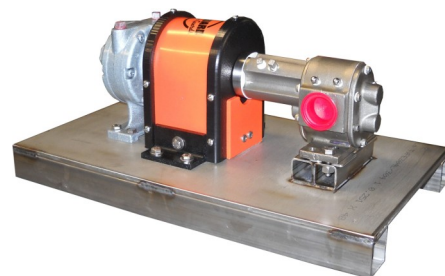

Model 8LOX, 304 SS Base with Air Motor



# Lobee Pump & Machinery Co.

## Industrial Pumps and Accessories

Since 1899...Noted for Highest Quality Pumps and Equipment

### Family of Quality Products



Simple in Design, Long in Life, Very Repairable

## POSITIVE DISPLACEMENT PUMP UNITS - 1/3 TO 5 HP

### Direct Mount Pump Units—Dimensional Layout

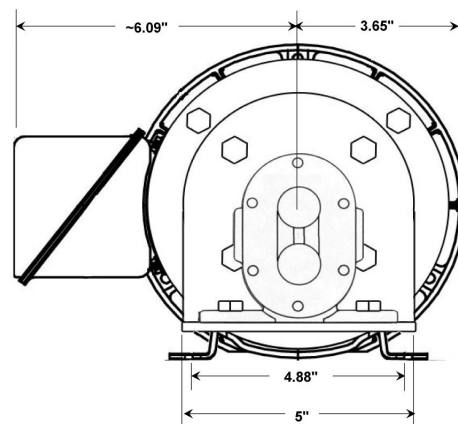
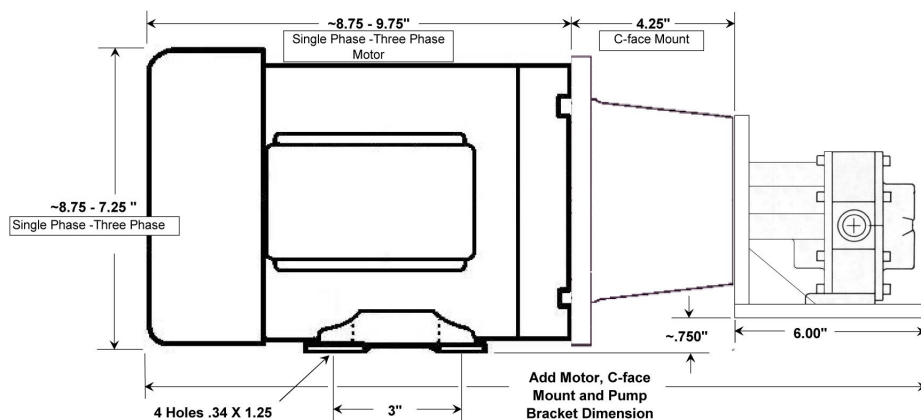

### Base Mount Pump Units—Dimensional Layout

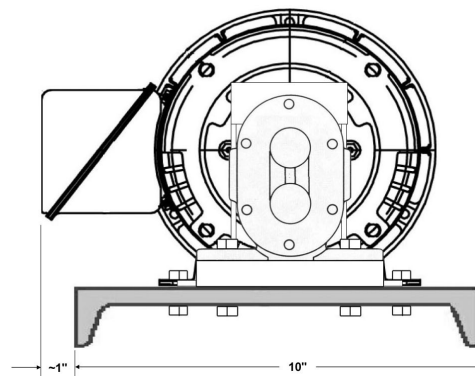
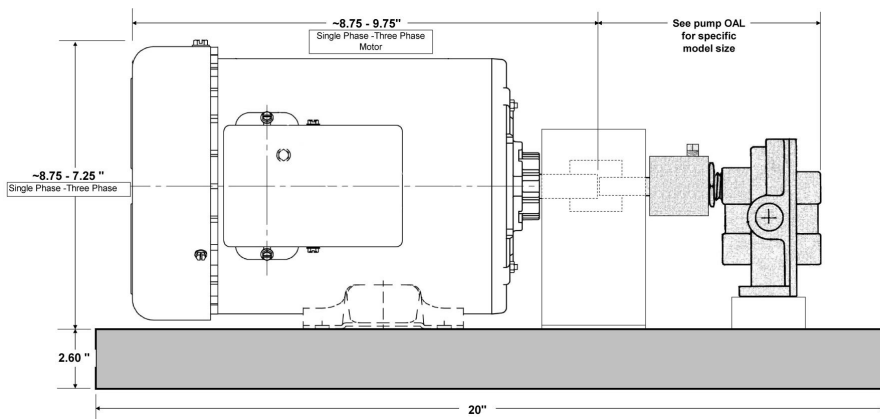

Actual dimensions will vary based on specific motor and pump combination used. Go to our website at [www.Lobee.com](http://www.Lobee.com) for detail dimensions.

#### Variable Speed Motor Drives



#### Speed Reducers for Viscous Liquids



#### Stainless Steel Alloys

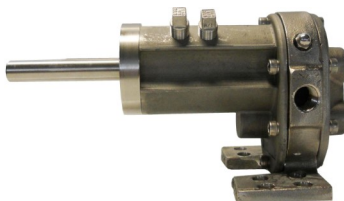

#### Bronze



#### Iron



#### Integral Adjustable Relief Valve

