

Lobee Pump and Machinery Co.

11/15/2011

LIST EFFECTIVE Nov 1, 2011

LOL PARTS CUTAWAY

Model LOL

FIG. NO.	PART NO.	DESCRIPTION	1LOL	2LOL	3LOL	4LOL	6LOL	8LOL	10LOL	12LOL
1	1 LOL-1	1/8" NPT Body	1							
1	2 LOL-1	1/4" NPT Body		1						
1	3LOL-1	3/8" NPT Body			1					
1	4 LOL-1	1/2" NPT Body				1				
1	6 LOL-1	3/4" NPT Body					1			
1	8 LOL-1	1" NPT Body						1		
1	10LOL-1	1-1/4" NPT Body							1	
1	12LOL-1	1-1/2" NPT Body								1
2	1 LOL-10	Cover	1							
2	2 LOL-10	Cover		1						
2	3 LOL-10	Cover			1	1				
2	6 LOL-10	Cover					1	1		
2	10LOL-10	Cover							1	1
3	1 LOL-26	Gasket	3							
3	2 LOL-26	Gasket		3						
3	3 LOL-26	Gasket			3	3				
3	6 LOL-26	Gasket					3	3		
3	10LOL-26	Gasket							3	3
5	1 LOL-703	Idle Gear Shaft Assembly	1							
5	2 LOL-703	Idle Gear Shaft Assembly		1						
5	3 LOL-703	Idle Gear Shaft Assembly			1					
5	4 LOL-703	Idle Gear Shaft Assembly				1	1			
5	8 LOL-703	Idle Gear Shaft Assembly						1		
5	10LOL-703	Idle Gear Shaft Assembly							1	
5	12LOL-703	Idle Gear Shaft Assembly								1
6	1 LOL-702	Drive Gear Shaft Assembly	1							
6	2 LOL-702	Drive Gear Shaft Assembly		1						
6	3 LOL-702	Drive Gear Shaft Assembly			1					
6	4LOL-702	Drive Gear Shaft Assembly				1	1			
6	8LOL-702	Drive Gear Shaft Assembly						1		
6	10LOL-702	Drive Gear Shaft Assembly							1	
6	12LOL-702	Drive Gear Shaft Assembly								1
7	2 LOL-52	Nut, Packing	1	1						
7	3 LOL-52	Nut, Packing			1	1	1	1		
7	10LOL-52	Nut, Packing							1	1
8, 15	2 LOL-77	Nut, Lock	1	1						
8, 15	3 LOL-77	Nut, Lock			1	1	1	1		
8	10LOL-77	Nut, Lock							1	1
10	6-186Q	Cover Screw	6							
10	8-186Q	Cover Screw		6	8	8				
10	10-186Q	Cover Screw					8	10		
10	1/4-164N	Cover Screw							10	10
11	3 LOS-59	Packing	1	1						
11	3 LOL-59-3	Packing			1					
11	3 LOL-59-4	Packing				1				
11	3 LOL-59-6	Packing					1			
11	3 LOL-59-8	Packing						1		
11	3 LOL-59-10	Packing							1	
11	3 LOL-59-12	Packing								1
14	2 LOL-49	Follower	1	1						
14	3 LOL-49	Follower			1	1	1	1		
14	10LOL-49	Follower							1	1
16	LH20-1	Seal housing, Bronze	1	1						
16	LH10-1	Seal housing, Bronze			1	1	1	1		
17	3LOS-27	1/8" NPT Brass Plug	1	1	1	1	1	1		
18	L2106-500	1/2" Type 2106 Viton Mech Seal	1	1						
18	L2106-625	5/8" Type 2106 Viton Mech Seal			1	1	1	1		
19	LM-RR2	Retaining Ring	1	1						
19	LH-RR1	Retaining Ring			1	1	1	1		
20	LSS-27KIT	1/2" Set Collar w/ Set Screws	1	1						
20	LSS28KIT	5/8" Set Collar w/ Set Screws			1	1	1	1		
21	LM-RM2	Seal Retainer	1	1						
21	LH-RM1	Seal Retainer			1	1	1	1		
22	LM-OV2	Viton O'ring	1	1						
22	LH-OV1	Viton O'ring			1	1	1	1		

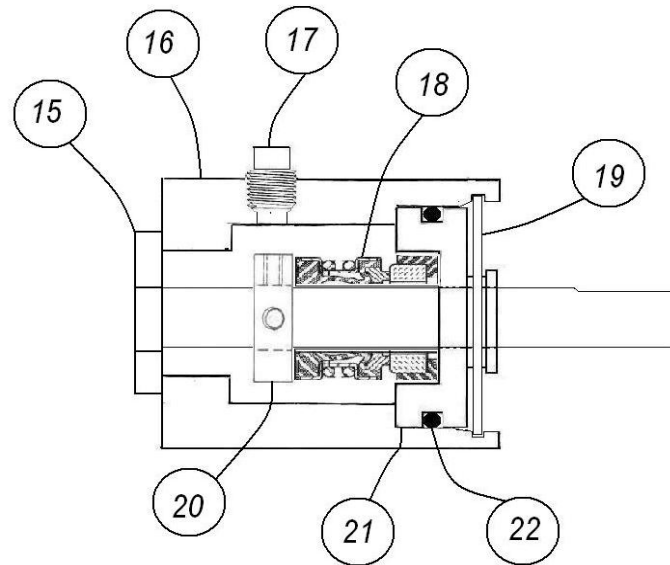
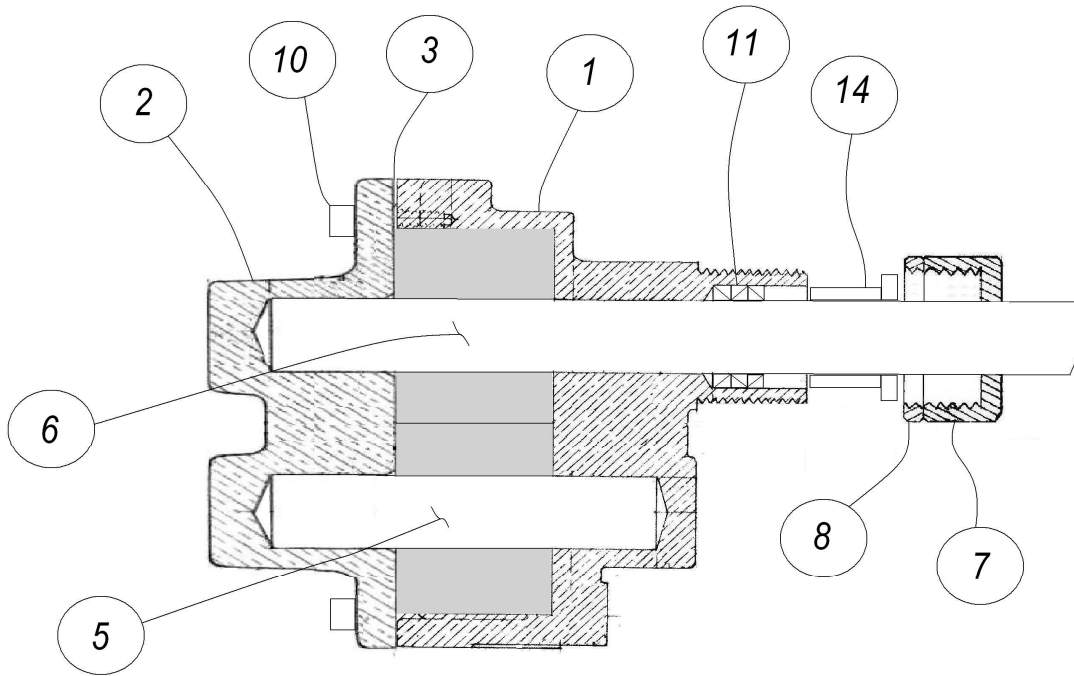

Optional Mechanical Shaft Seal